



Art of Smooth Performance

VTURN S26/S36

Strong
and
Steady
Turning
Center

- Servo turret (S26, S26CM, S36CM)
- One-piece slant bed
- Box slideways
- High thrust force
- High Rapid feeds
- Rotary operation panel



Victor Taichung – an established ISO 9001, 14001 & 45001 company



Smooth & Steady Performance

Vturn-S26 Turning center

- One piece 30° slant bed
- Large swing diameter 600 mm
- 10" Power chuck / 3500 rpm
- Z-axis travel 610 / 1100 mm (S26/60, S26/110)
- High thrust force 1441 kgf
- High rapid feed 18/24 m/min (X/Z)
- Machine weight 5830 / 6430 kg (S26/60, S26/110)
- C-axis available

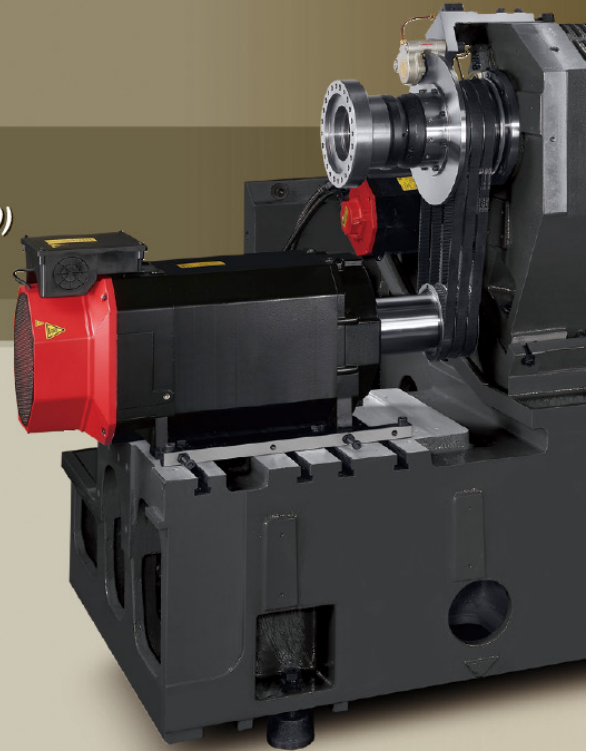

Spindle 22kW (S3-25%)

- Spindle output 574 Nm (S3-25%)
- Low base speed 307 rpm only
- NN type (roller type) bearings
- Shortened belt length
- Victor Taichung's own spindle

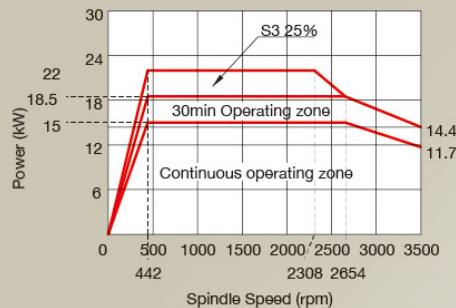
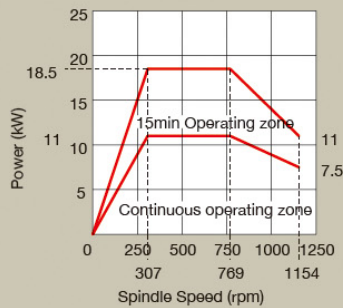
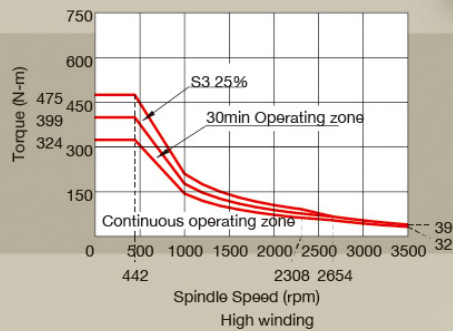
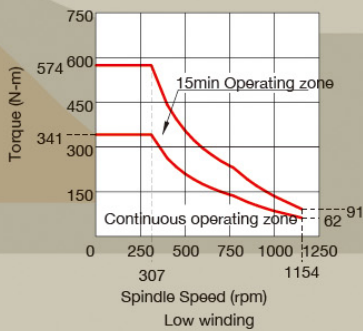

Conventional design with much longer belts



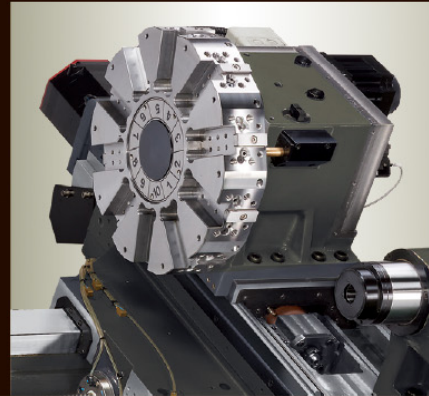
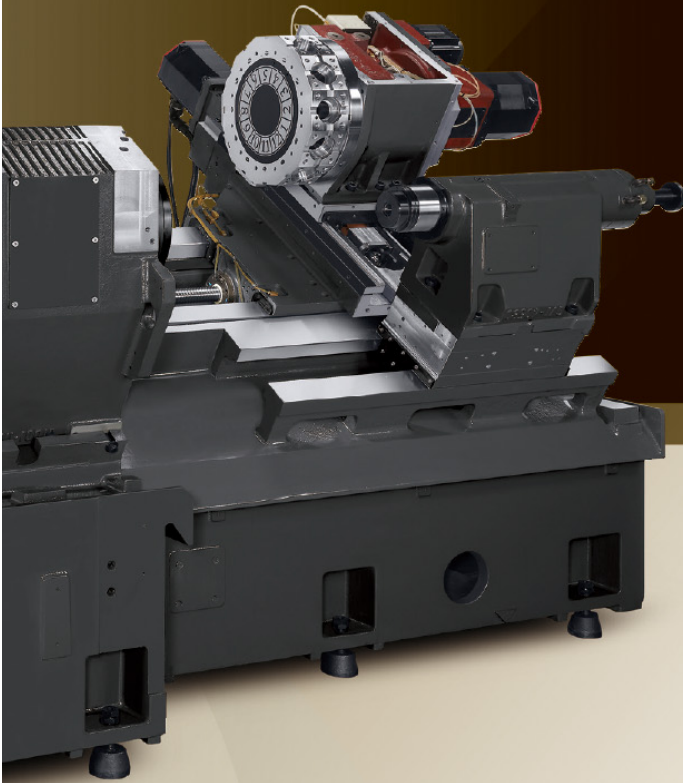

Servo Turret 0.8 sec. (adjacent tools)

- Victor Taichung's own turret
- Turret indexing time 0.8 sec (adj.), 1.0 (opposite)
- High thrust (Z-axis) 1441 kgf (14.1 kN)
- Milling turret BMT-65 (3-piece coupling)
- 12 stations live tools
- Milling power 4.5kW/4000rpm (opt. 6000rpm)



Certificated Casting
GA350

Tailstock MT-5

- Twin cylinder clamping
- Tow along by turret
- Opt. MT-4 with built-in bearings

Boxways 64/80 mm (X/Z)

- High rapid feeds 18/24 m/min
- Smooth operation guaranteed
- Victor Taichung's own casting

Opt. Spindle 26kW (S3-25%)

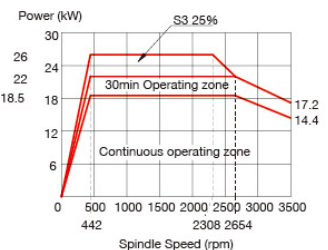
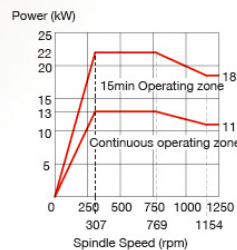
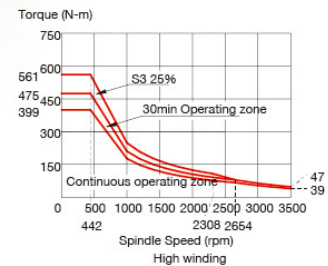
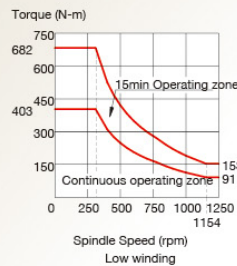

Smooth & Steady Performance

Vturn-S36 Turning center

- A2-11 spindle with 2-step gearbox
- One piece 45° slant bed
- Large swing diameter 680 mm
- 12" Power chuck / 2500 rpm
- Z-axis travel 850 mm
- High thrust force 1582 kgf
- High rapid feed 18/20 m/min (X/Z)
- C-axis available with higher power spindle motor



2-step gearbox

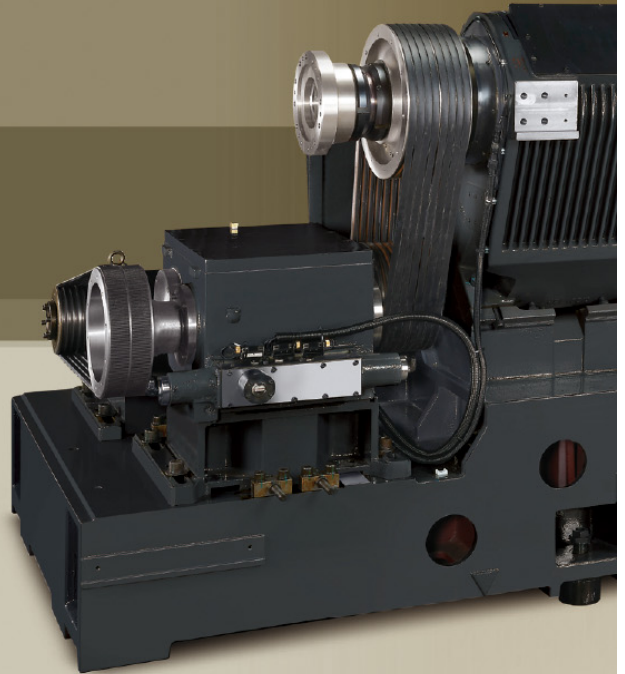

Spindle 26kW (S3-25%)

- Spindle nose A2-11 with 2-step gearbox
- Spindle output 1201 Nm (S3-15%)

- Low base speed 278 rpm only
- NN type (roller type) bearings

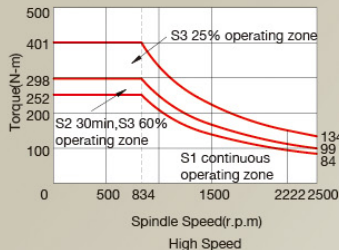
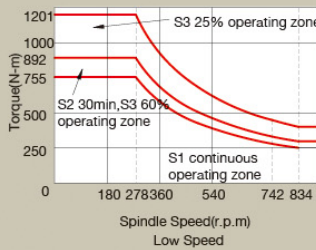
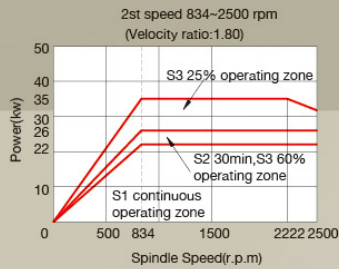
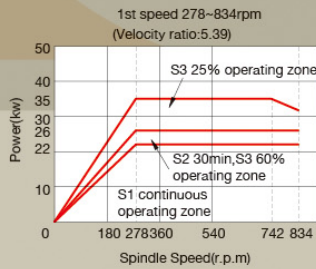

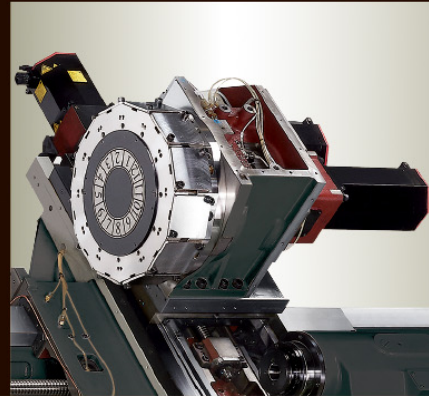

Victor's Own Turret

- Turret indexing time 0.9 sec. (adj.), 1.8 sec. (opposite)
- High thrust (Z-axis) 1582 kgf (15.5 kN)
- Opt. milling turret BMT-75 (3-piece coupling)
- 12 stations live tools
- Milling power 7 kW / 3000 rpm

Boxways 85/90 mm (X/Z)

- High rapid feeds 18/20 m/min
- Smooth operation guaranteed

Tailstock MT-5

- Twin cylinder clamping
- Tow along by turret
- Opt. MT-4 with built-in bearings

Cs-axis (opt.) with GTP® gearbox and upgraded spindle motor 45 kW (S3-25%)

- GTP® 2-step gearbox
- Spindle output 2010 Nm (S3-15%)
- Low base speed 214 rpm only

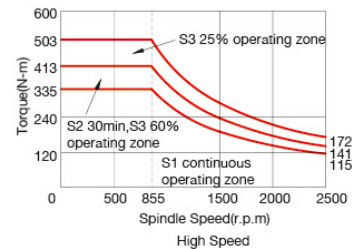
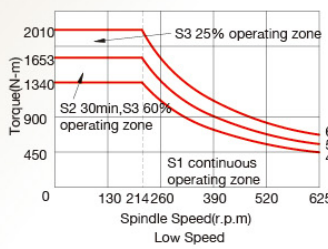
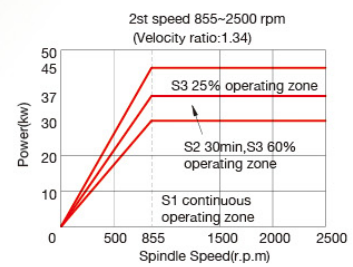
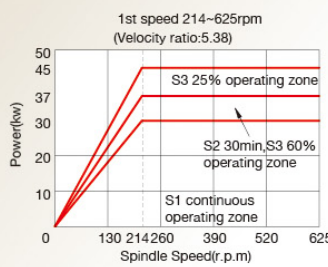
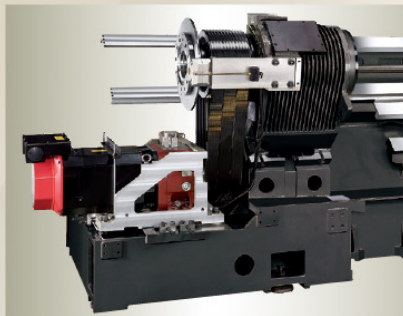

Standard and Options

- Fanuc Oi-TF Plus (type-1) control with 10.4" screen
- Programmable tailstock (MT-5)
- Rotary operation panel
- Door moving along LM guideways
- Coolant flush onto Z-axis covers
- Built-in LED light
- Chip conveyor



Conveyor motor cover (opt.)

Chip conveyor (std.)



Coolant flush (std.)



Tooling accessories (excl. BMT turret model)

TOOLS \ MODEL	Vturn-S26	Vturn-S36
Tool shank for turret disk	25 mm (1")	32 mm (1 1/4")
Maximum boring bar dia.	50 mm (2")	50 mm (2")
Face + OD cutting tool holder	1	1
Face + I.D. cutting tool holder	1	1
Boring bar holder		
40 mm (1 1/2")	7	-
50 mm (2")	1	5
Boring bar sleeve		
8 mm (5/16")	1	-
10 mm (3/8")	2	1
12 mm (1/2")	2	1
16mm (5/8")	2	2
20 mm (3/4")	2	2
25 mm (1")	2	2
32 mm (1 1/4")	2	2
40 mm (1 1/2")	-	2
Drill socket		
MT1	Opt.	-
MT2	1	-
MT3	1	Opt.
MT4	1	1
U drill socket		
20 mm	Opt.	-
25 mm (1")	1	1
32 mm (1 1/4")	1	1
40 mm (1 1/2")	-	Opt.

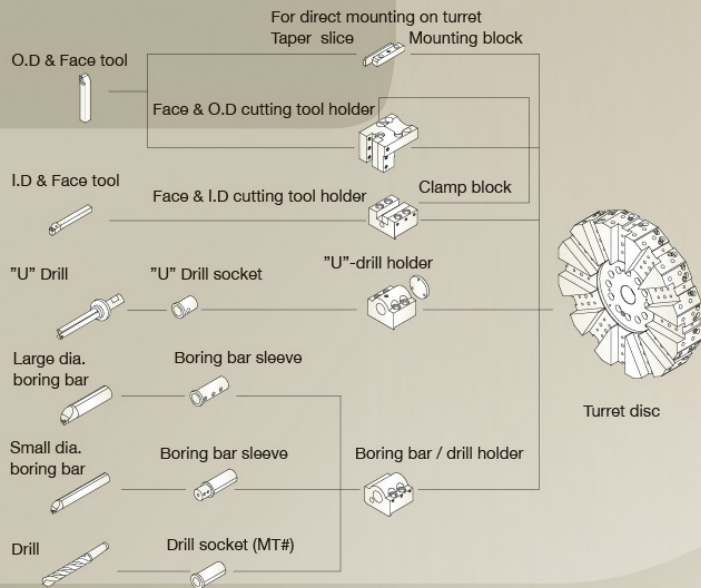



Transformer, A/C for cabinet (opt.)



15" screen (opt.)

Tool presetter (opt.)

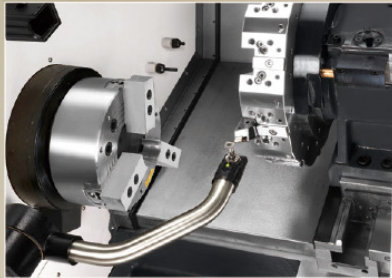

Gantry robot (opt.)



Recessed guarding for long tools (opt.)

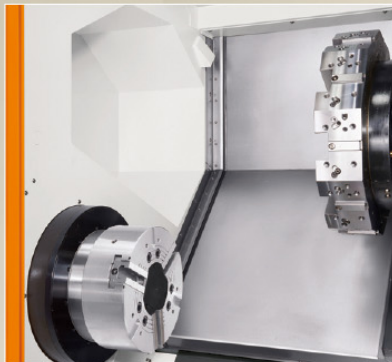

Part catcher (opt.)



Oil skimmer (opt.)



Machine Color Option



Standard



RAL-7024

VICTOR Taichung's FANUC Oi-TF Plus 10.4" Control (Type I) Specifications

Standard

ITEM/SPECIFICATION	DESCRIPTION
Controlled Axes:	
1. Controlled axes	2 Axes (X, Z)
2. Simultaneous controlled axes	2 Axes
3. Least input increment	0.001mm
4. Least command increment	0.0005mm (X) / 0.001mm (Z)
5. Command system	Incremental / Absolute
6. HRV Control	HRV3+
7. Unexpected disturbance torque detection (AIR-BAG)	Std.
8. Backlash compensation	Std.
9. Stored pitch error compensation	Std.
Operation & Program Input:	
1. Input / Output interface	RS-232, PCMCIA Card, USB
2. Tool offset	99 sets
3. Sequence number	N5-Digit
4. Program number	O8-Digit
5. Program name	31-characters
6. M code function	M3-digit
7. S code function	S4-digit
8. T code function	T4-digit
9. Positioning	G00
10. Linear interpolation	G01
11. Circular interpolation	G02, G03
12. Programmable data input	G10
13. Plane selection	G17-G19
14. Inch / Metric conversion	G20 / G21
15. Reference position return	G28, G30
16. Thread cutting	G32, G34
17. Threading retract	Std.
18. Tool nose radius compensation	G40-G42
19. Work piece coordinate system	G52-G59
20. Macro, Sub program call	G65, M98, M99 (10 folds nested)
21. Multiple repetitive cycle I & II	G70-G76
22. Canned cycle for drilling	G80-G89
23. Canned cycles	G90, G92, G94
24. Program stop / end	M00-M02 / M30
25. Rigid tapping (Spindle)	M29
26. Manual Guide i	Std.
27. Optional blocks skip 2-9	Std.

Feed Function:

1. Manual handle feed rate	X1, X10, X100
2. Rapid traverse rate	F0, 25%, 50%, 100%
3. Cutting feed rate	0-150%
4. Spindle override	50-120%
5. Feed per Minute / Revolution	G98 / G99

Edit Operation:

1. Part Program Storage Length (in total)	5120m (2MB)
2. Number of Registerable programs (in total)	1000
3. Part Program Editing	Std.

C Axis Function:

1. Polar coordinate interpolation	Std. (G112/G113)
2. Cylindrical interpolation	Std. (G107)
3. CS contouring control	Std.
4. Spindle control with servo motor	G98.4
5. Coordinate System Rotation	Std.
6. Cylindrical Interpolation	Std. (G107)
7. Coordinate System Rotation	Std.

OPTIONS

With hardware included

1. Tool life management	<input type="checkbox"/>
2. Program restart	<input type="checkbox"/>
3. Data server (with PCB and CF card 1GB)	<input type="checkbox"/>
4. Ethernet/IP (to be linked to robot)	<input type="checkbox"/>
5. PROFIBUS-DP (to be linked to robot)	<input type="checkbox"/>
6. CC-Link (to be linked to robot)	<input type="checkbox"/>
7. Fast Ethernet (required for SCADA Web with additional RJ45 port)	<input type="checkbox"/>

Without hardware included

8. Circular thread cutting (G35, G36)	<input type="checkbox"/>
9. AICC-1 (G5.1 O1, 40 blocks)	<input type="checkbox"/>
10. AICC-2 (G5.1 O1, 200 blocks)	<input type="checkbox"/>
11. Helical interpolation (C-axis only)	<input type="checkbox"/>
12. Arbitrary speed threading	<input type="checkbox"/>
13. Memory card program entry count extension (Max. 1000)	<input type="checkbox"/>

C-axis Application (Bolt Mounted Milling Turret)

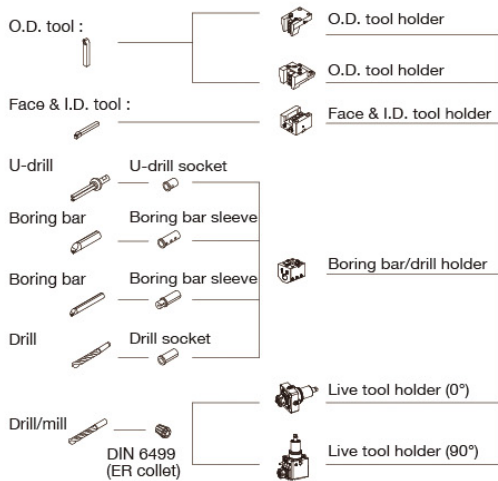

BMT-65 (Vturn-S26CM)

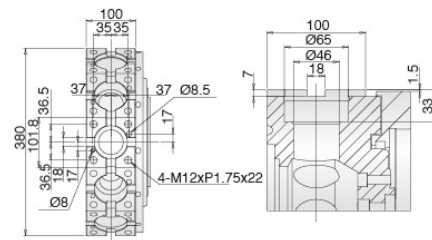

BMT-75 (Vturn-S36CM)

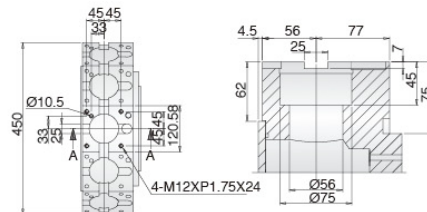

Interference Chart / Operating Range



Vturn-S26

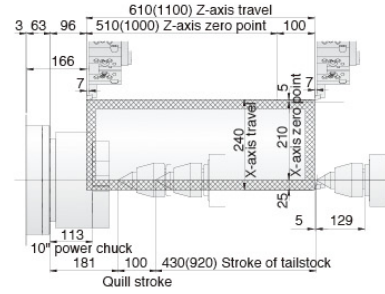
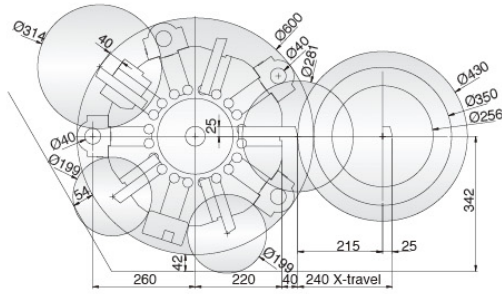

Vturn-S26CM

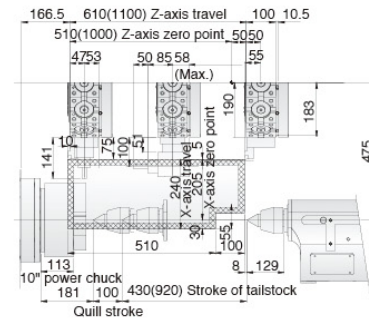
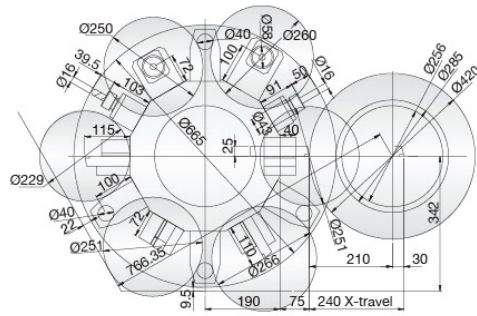

Vturn-S36

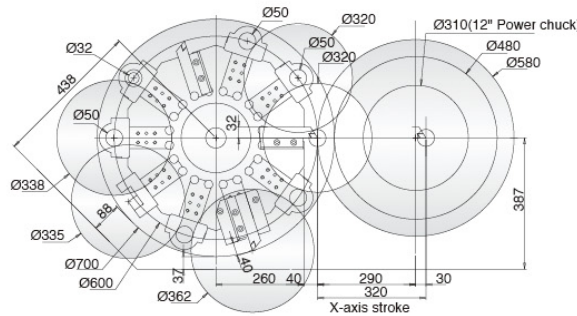

Vturn-S26/60 (S26/110)

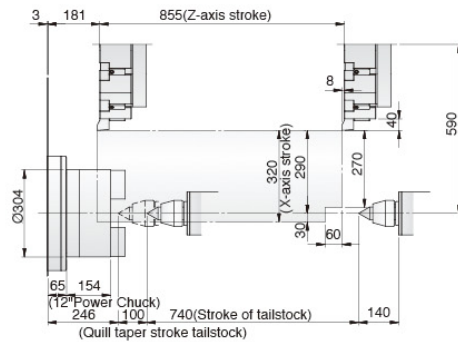

Vturn-S36CM

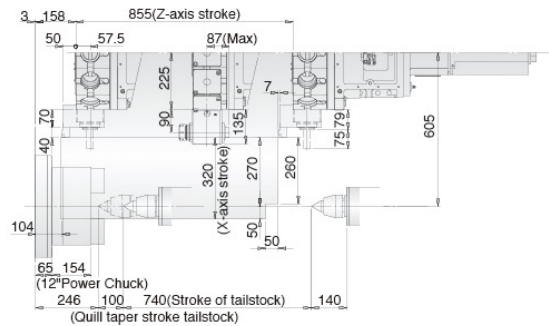
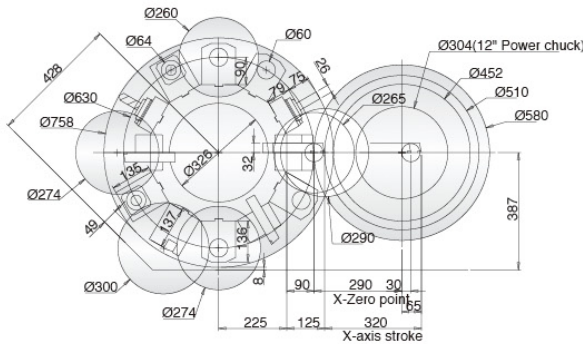

Machine Layout

Vturn-S26/60

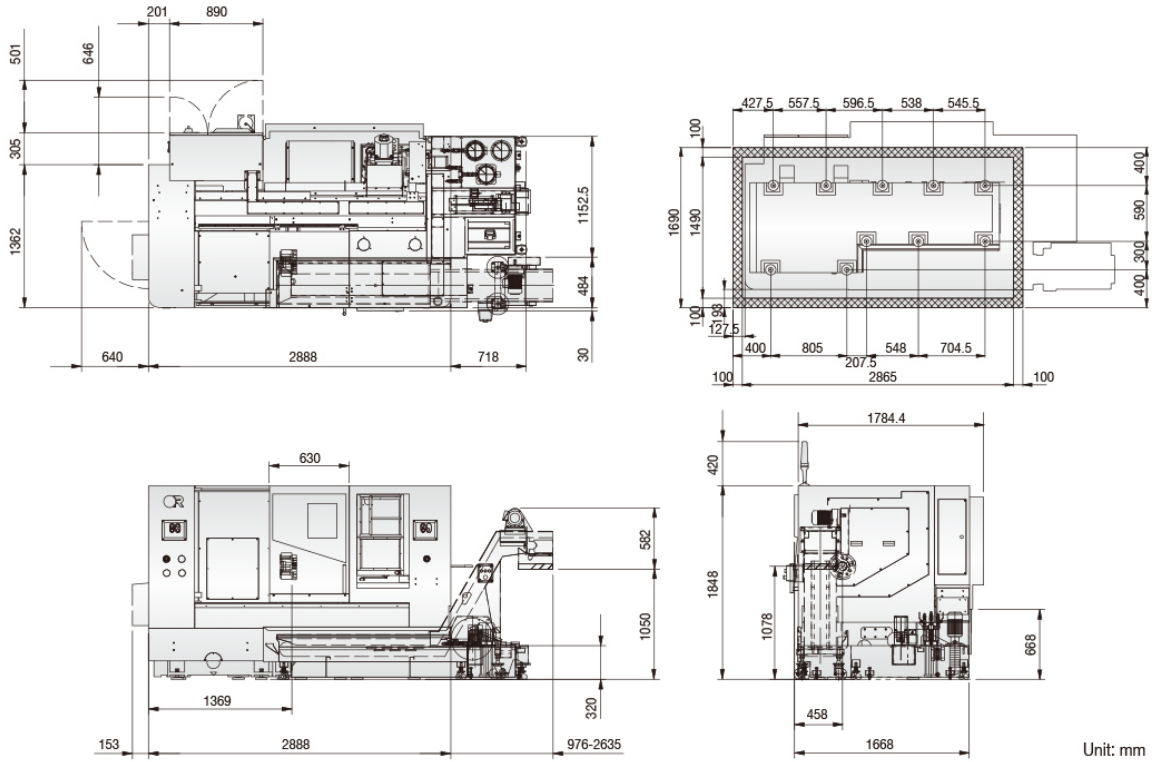

Vturn-S26/110

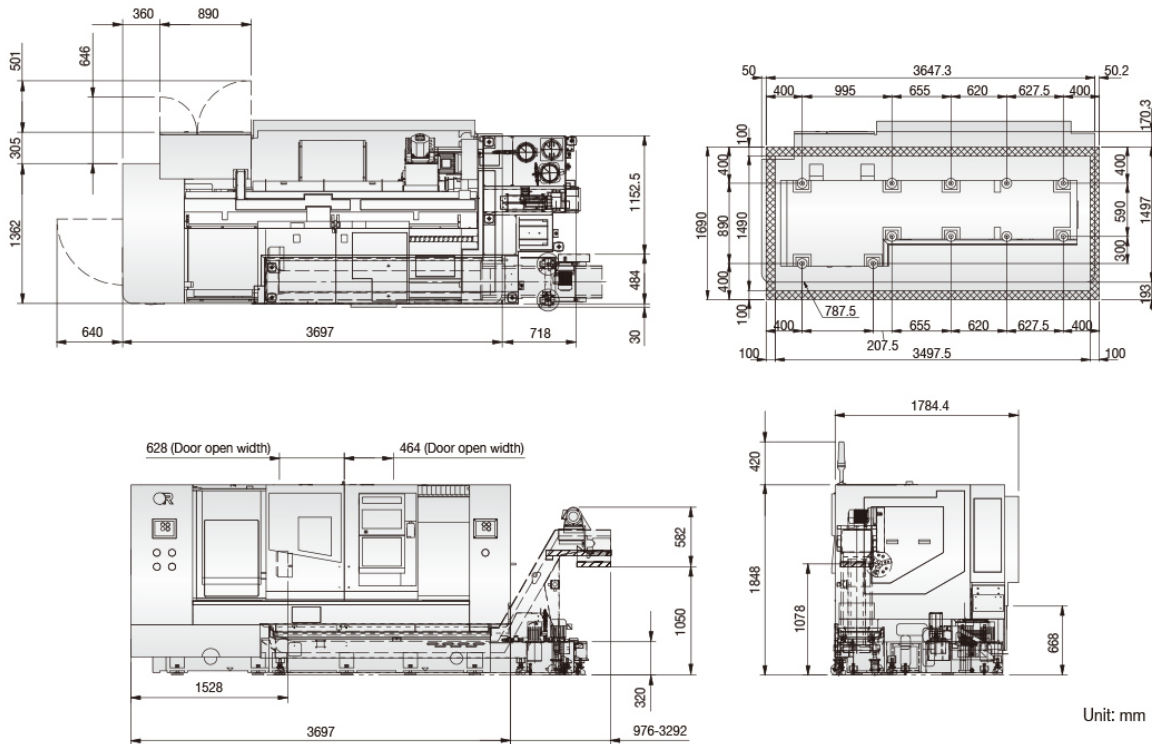



Vturn-S36/85

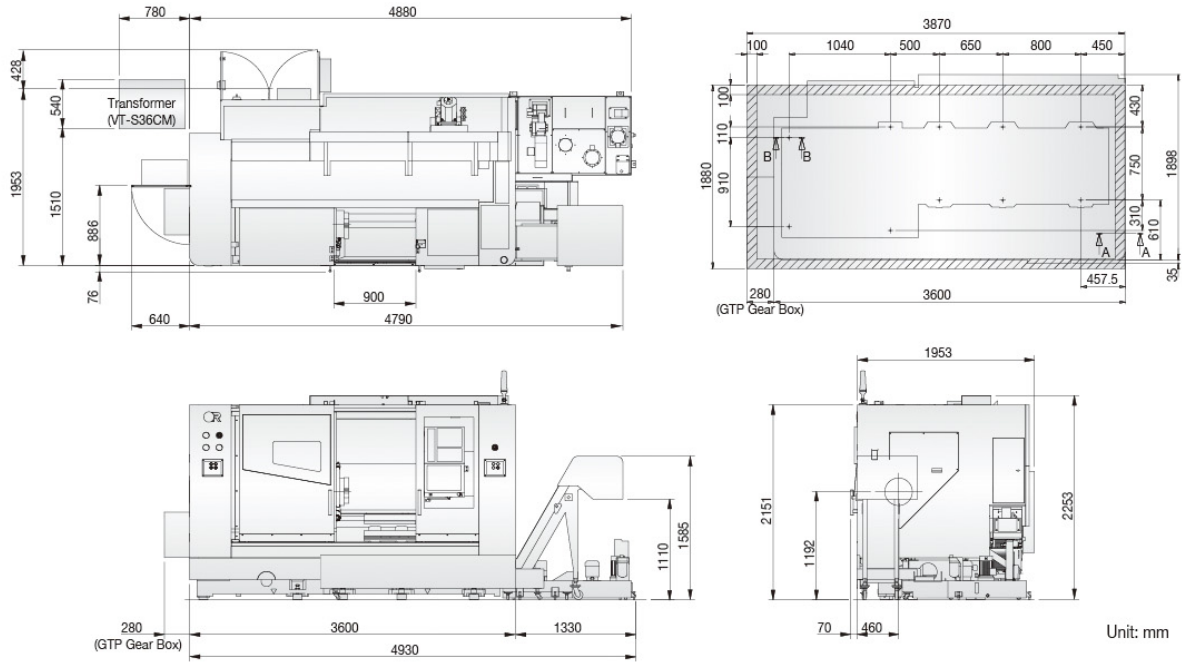

Milling / Drilling Tool Output

Vturn-S26CM

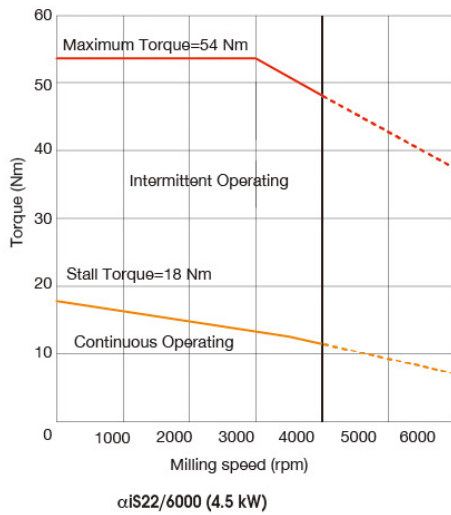

Vturn-S36CM

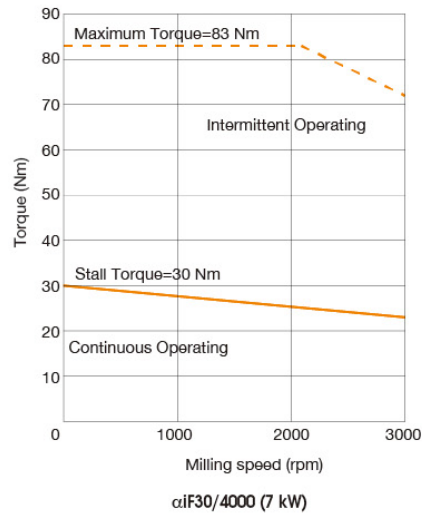

Machine Specification

Item	Unit	Vturn-S26/60 (CM) Vturn-S26/110 (CM)	Vturn-S36/85 (CM)	
CAPACITY	Swing over bed dia.	mm	ø600	ø780
	Standard turning dia.	mm	ø350 (ø285)	ø480 (ø452)
	Maximum turning dia.	mm	ø430 (ø420)	ø580 (ø580)
	Swing over carriage dia.	mm	ø480	ø600
	Between centers	mm	640 1130	898
	Bar capacity (Hole thru draw bar)	mm	ø75 (opt. 77, 91)	ø91 (opt. 117.5)
AXIS FEEDS	X axis travel	mm	215+25 (210+30)	290+30 (270+50)
	Z axis travel	mm	610 1100	855
	Rapid feed - X / Z axis	m/min	18 / 24	18 / 20
	Feed motor - X / Z axis	kW	3 / 4	3 / 4 (4 / 4)
	JOG feed	mm/min	X/Z: 0~1260	X/Z: 0~1260
	Ball screw dia x pitch	mm	ø32xP6 (X), ø40xP8 (Z)	ø36xP6 (X), ø50xP8 (Z)
	SPINDLE	Spindle speed	rpm	3500 (opt. 2500)
Spindle nose (chuck)		inch	A2-8 (10")	A2-11 (12")
Spindle motor power (cont./30min/25%)		kW	15 / 18.5 / 22 (opt. 18.5 / 22 / 26)	22 / 26 / 35 (opt. 30 / 37 / 45)
Spindle bearing inside dia.		mm	ø130	ø160
Spindle bore		mm	87	105 (opt. 135)
Spindle taper			1/20	1/20
TURRET	No. of tools (live)		10 (12 servo)	10 (12 servo)
	Tool shank size	mm	□25	□32
	Max. boring bar dia.	mm	ø50 (BMT-65)	ø50 (BMT-75)
	Exchange time (T-T)	sec	0.8 (0.81) - adjacent 1.0 (1.25) - opposite	0.9 (1.36) - adjacent 1.78 (1.8) - opposite
	Milling speed	rpm	4000 (opt. 6000)	3000
	Milling motor	kW	4.5	7
TAILSTOCK	Tailstock quill dia.	mm	ø110	ø110
	Quill stroke	mm	100	100
	Quill taper		MT #5 (opt. MT#4)	MT #5 (opt. MT#4)
CAPACITY	NC controller	Fanuc	0i-TF Plus (10.4")	0i-TF Plus (10.4")
	Coolant tank capacity	L	330 380	250 (overflow type)
	Power requirement	kVA	27 (29)	38 (46)
	Machine dimension LxWxH (with chip conveyor)	mm	4017 x 1848 x 1819 4673 x 1848 x 1819	4930 x 2029 x 2253 (5210 x 2029 x 2253)
	Net weight (incl. std. accessories)	kgs	6130 (6230) 6730 (6830)	9000 (9100)

* Machine and controller specifications are subject to change without notice.

Standard Accessories:

- Fanuc 0i-TF Plus (10.4") with Manual Guide i
- Hydraulic chuck with soft jaws
- Programmable tailstock
- Chip conveyor
- Fully enclosed splash guarding
- Hand wheel
- Tool holders (for standard turret only)
- Coolant flush on Z-axis cover
- 3 step warning light

Optional Accessories:

- Manual tool presetter
- Auto tool presetter
- Part catcher (swing type) - Vturn-S26 only
- KITAGAWA® power chuck
- Air conditioner for electrical cabinet (Panel cooler)
- 12" chuck (3000 rpm spindle) (Vturn-S26)
- Higher pressure coolants
- Bar feeder interface
- Air blow
- Oil skimmer
- Oil mist collector
- Auto door
- Hard jaws
- Tailstock center
- Transformer
- C-axis (Vturn-S26CM/S36CM)



THE VICTOR-TAICHUNG COMPANIES

TAIWAN

http://www.victortaichung.com
E-mail :info@mail.or.com.tw

- Victor Taichung Machinery Works Co., Ltd.
No. 1, Jingke Central 2nd Rd.,
Nantun Dist., Taichung 40852,
TAIWAN, R.O.C.
TEL : 886-4-23592101
FAX : 886-4-23593389

FRANCE

- Victor France
TEL : 33-1-64772000
FAX : 33-1-64772063

GERMANY

- Victor GmbH
TEL : 49-2261-478434
FAX : 49-2261-478327

SOUTH AFRICA

- Victor Fortune (PTY) Ltd.
TEL : 27-11-3923800
FAX : 27-11-3923899



profile:
Sales turnover: USD 156 mil's (in 2020)*
No. of employees: 796
*Exchange rate: 1 USD=28.5 TWD.



HTL



VTL



VMC



HMC



XMT



PIM

MALAYSIA

- Victor Machinery (M) SDN. BHD.
TEL : 60-3-56337180
FAX : 60-3-56337191

THAILAND

- Victor (Thailand) Co. Ltd.
TEL : 66-2-9263735
FAX : 66-2-9032373

INDONESIA

- PT. Victor Machinery Indonesia
TEL : +62-21-88958504
FAX : +62-21-88958513

USA

- Fortune International Inc.
TEL : 1-732-2140700
FAX : 1-732-2140701

CHINA

- Victor Taichung Machinery (Shanghai)
TEL : 86-21-59768018
FAX : 86-21-59768009



was also marketed under the brand names **VICTOR** (outside North America) and **FORTUNE** GV1GE21EE